

Report to:	Licensing and Regulatory Committee	Date of Meeting:	Monday 12 June 2023
Subject:	Junction Improvements in Crosby Village – Islington/Church Road/ Coronation Road and Coronation Road/ The By -Pass		
Report of:	Assistant Director of Place (Highways and Public Protection)	Wards Affected:	Victoria, Blundellsands and Victoria
Portfolio:	Locality Services		
Is this a Key Decision:	No	Included in Forward Plan:	No
Exempt Confidential Report:	/ No		

Summary:

This report is to seek Committees approval for changes to the two junctions in Crosby centre. The principal change includes the introduction of traffic signals to replace the double mini roundabout arrangement at the junction of Islington with Church Road and Coronation Road. This signal controlled junction will include push button crossing facilities to improve accessibility.

Modification will also be introduced to the junction of the A565 Liverpool Road and the By Pass with Coronation Road to improve safety and accessibility and ensure that both signals work together.

Recommendation(s):

It is recommended that the Assistant Director of Highways and Public Protection be authorised to implement the following modifications to the highway:

- (1) Introduction of a signal controlled junction with push button crossing facilities to replace the existing double mini roundabout arrangement at the junction of Islington, Church Road with Coronation Road.
- (2) Modifications to the junction of The Bypass/ Liverpool Road (A565) and Coronation Road including improved crossing facilities.

Reasons for the Recommendation(s):

Licensing and Regulatory Committee have powers to consider the outcome of consultation and the resultant proposals in respect of the making of traffic regulation

orders, details of improvements to highways and cycle routes and can approve the scheme as proposed or with minor amendments but otherwise must refer the scheme to the Cabinet Member.

Alternative Options Considered and Rejected: (including any Risk Implications)

A number of options for improved access into Crosby centre were considered as part of the Crosby Town Centre Access Study completed in 2018. The proposals, which included modifications to the car parks and changes to the highway network considered a number of options. The proposals set out in this report were considered to be the most appropriate in improving facilities for pedestrians whilst maintaining traffic flow.

What will it cost and how will it be financed?

(A) Revenue Costs

No revenue cost implications.

(B) Capital Costs

The capital cost for the scheme will be funded from the £1.5m allocation within the 23-24 Transport Capital Programme. This funding was allocated to the Council as part of the Year 2 of the 5 year City Region Sustainable Transport Settlement.

Implications of the Proposals:

Resource Implications (Financial, IT, Staffing and Assets): All costs are funded from the appropriate budget line within the Transport Capital programme.	
Legal Implications: Any legal implications are incorporated in the report.	
Equality Implications: The scheme is aimed at improving access to the centre of Crosby from the west for pedestrians and cyclists which will benefit people with protected characteristics.	
Impact on Children and Young People: No	
Climate Emergency Implications: The recommendations within this report will	
Have a positive impact	Yes/No

Have a neutral impact	Yes/No
Have a negative impact	Yes/No
The Author has undertaken the Climate Emergency training for report authors	Yes/No

The construction process will have negative impact in that new materials will be used and there will be a net carbon impact.

However, the scheme when implemented, will improve accessibility and should encourage people to walk or cycle to the centre, particularly from the west, rather than drive. This should reduce the carbon impact.

Contribution to the Council's Core Purpose:

Protect the most vulnerable: Not applicable.
Facilitate confident and resilient communities: The scheme should improve walking and cycling in the local area by making Crosby Centre easier to access and reducing severance.
Commission, broker and provide core services: Not applicable.
Place – leadership and influencer: The scheme will enable and be complementary to the proposals.
Drivers of change and reform: Not applicable
Facilitate sustainable economic prosperity: The scheme should help improve access to the proposed new development on the Green Car Park site.
Greater income for social investment: Not applicable.
Cleaner Greener The scheme should improve walking and cycling in the local area by making Crosby Centre easier to access on foot.

What consultations have taken place on the proposals and when?

(A) Internal Consultations

The Executive Director of Corporate Resources and Customer Services (FD.7260/23) and the Chief Legal and Democratic Officer (LD.5460/23) have been consulted and any comments have been incorporated into the report.

(B) External Consultations

Consultation on the highway proposals formed part of the wider consultation on development proposals for the village centred on the creation of a new library and health centre facilities on the current Green Car Park. On line and in person discussions were held with stakeholders and members of the public.

Implementation Date for the Decision

Immediately following the Committee meeting.

Contact Officer:	
Telephone Number:	07866 176195
Email Address:	Andrew.Dunsmore@sefton.gov.uk

Appendices:

Appendix A – Plan showing the proposed changes.

Background Papers:

There are no background papers available for inspection.

1. Introduction/ Background

- 1.1 Following completion of the Crosby Investment Strategy and Crosby Village Feasibility Study the need for an improved access to Crosby centre, particularly for pedestrians, was identified. A Crosby Town Centre Access Study was commissioned to review, amongst other things, routes within and to the centre from the surrounding areas.
- 1.2 A number of options for improvement were identified within the town centre including modifications to the layouts of two of the car parks aimed at improving capacity thus enabling development to progress on the Green Car Park.
- 1.3 Also included were proposals to remove the double mini roundabout forming the junction of Islington with both Coronation Road and Church Road and replacement with a signal controlled junction.
- 1.4 This has the advantage of ensuring that pedestrians had a safe push button controlled crossing point across both Islington and Coronation Road. At present this is difficult and a number of requests have been made from residents for improved crossing facilities in this area.
- 1.5 Acknowledging the close proximity of this proposed new signal installation to the main signal controlled junction on the A565, it was appreciated that the two sets of signals would need to be linked in order to ensure flow of traffic. As such a microsimulation model was created and this has helped identify the phasing of both junctions.
- 1.6 The proposed modifications to the two car parks included proposals for a new access from the By Pass into Cookslands car park which would have the potential advantage of increasing its attractiveness and use. It was recognised that to ensure a potential new arrangement worked safely there would be some advantage in having just one right turn lane from Liverpool Road. Whilst this could be deemed to have a negative impact on capacity at the junction it was recognised that the two right turn lanes on Liverpool Road are rarely used to their capacity, largely as a result of parked cars on the northbound approach. Site observations also identified that when two cars leave the junction there can be some significant acceleration by some drivers. Having one turn lane could help deter this.
- 1.7 In developing the outline proposals for the new library proposals the benefit of ensuring high quality public realm within the vicinity of the proposals was recognised. Some initial work was completed to identify themes and possible materials. The proposed highway improvement works provide an opportunity to incorporate these materials to set a high standard for Crosby.

2. Feedback from Consultation

- 2.1 Whilst the focus of the consultation completed in late 2021 was on the proposals for the new library, the proposals identified within Appendix A were largely well received.

2.2 A number of key points were identified, covering a range of issues. In response to some points raised a walking audit has been completed and some minor changes to the proposals made.

3. Scheme Proposals and Funding

3.1 It is proposed to deliver the removal of the double mini roundabout and replacement with a signalised junction and complete the associated modification to the junction on the A565 as one scheme. These proposals are identified in Appendix A.

3.2 Acknowledging the benefit that improved accessibility to the town centre that the scheme provides, particularly in light of the aspiration for the new library facility, the Liverpool City Region Combined Authority agreed to include an allocation of funding to the Year 2 (2023/24) of the City Region Sustainable Transport Settlement.

3.3 The detailed design is nearing completion and a Safety Audit undertaken. A further Audit will be completed prior to construction. Consideration has been given to the sequence of construction with a view to the works commencing in the Autumn 2023, subject to approval.

4. Recommendation

4.1 It is recommended that the Assistant Director of Highways and Public Protection be authorised to implement the following modifications to the highway:

- (1) Introduction of a signal controlled junction with push button crossing facilities to replace the existing double mini roundabout arrangement at the junction of Islington, Church Road with Coronation Road.
- (2) Modifications to the junction of The Bypass/ Liverpool Road (A565) and Coronation Road including improved crossing facilities.

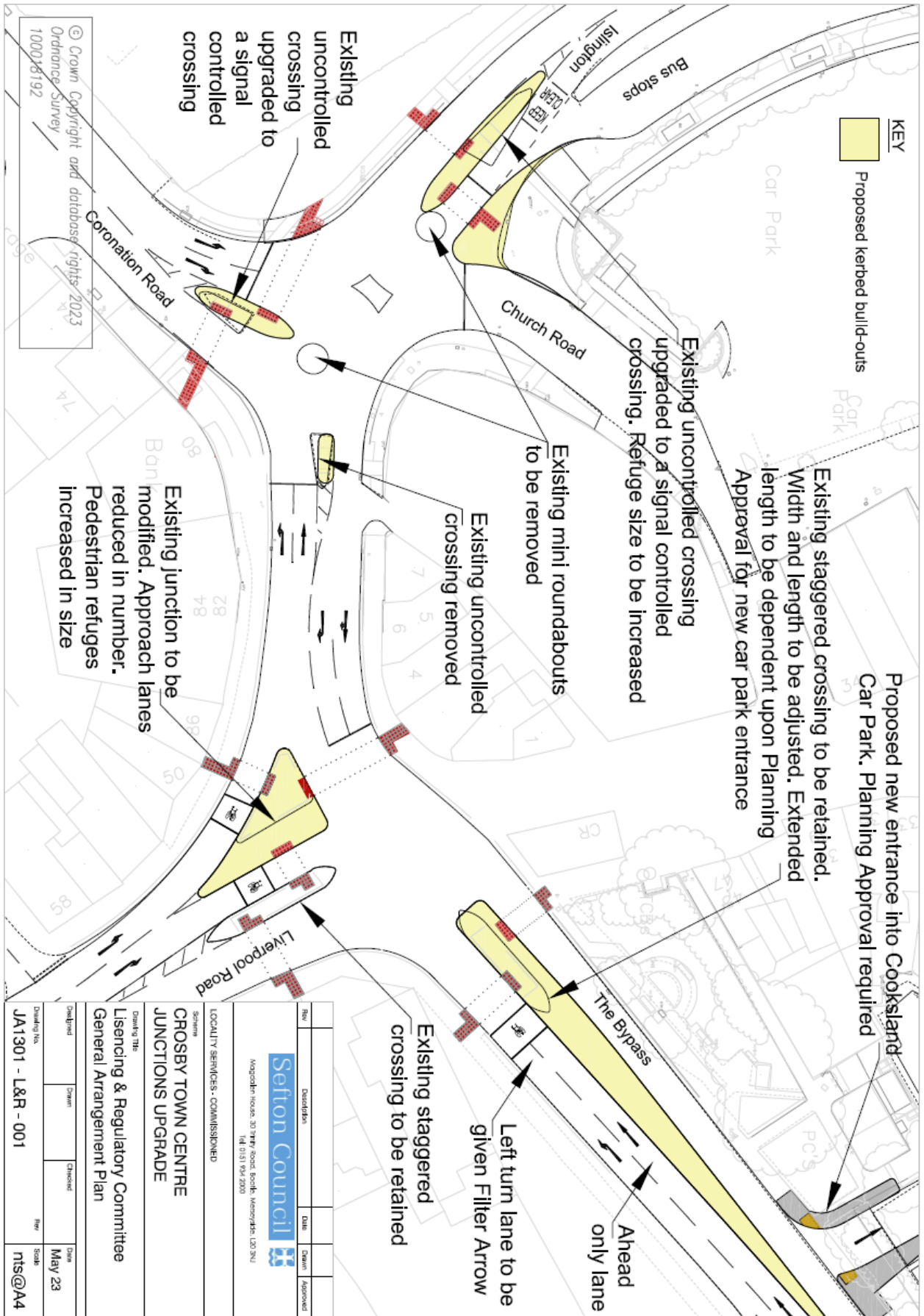

Appendix A – Plan showing the proposed changes.